

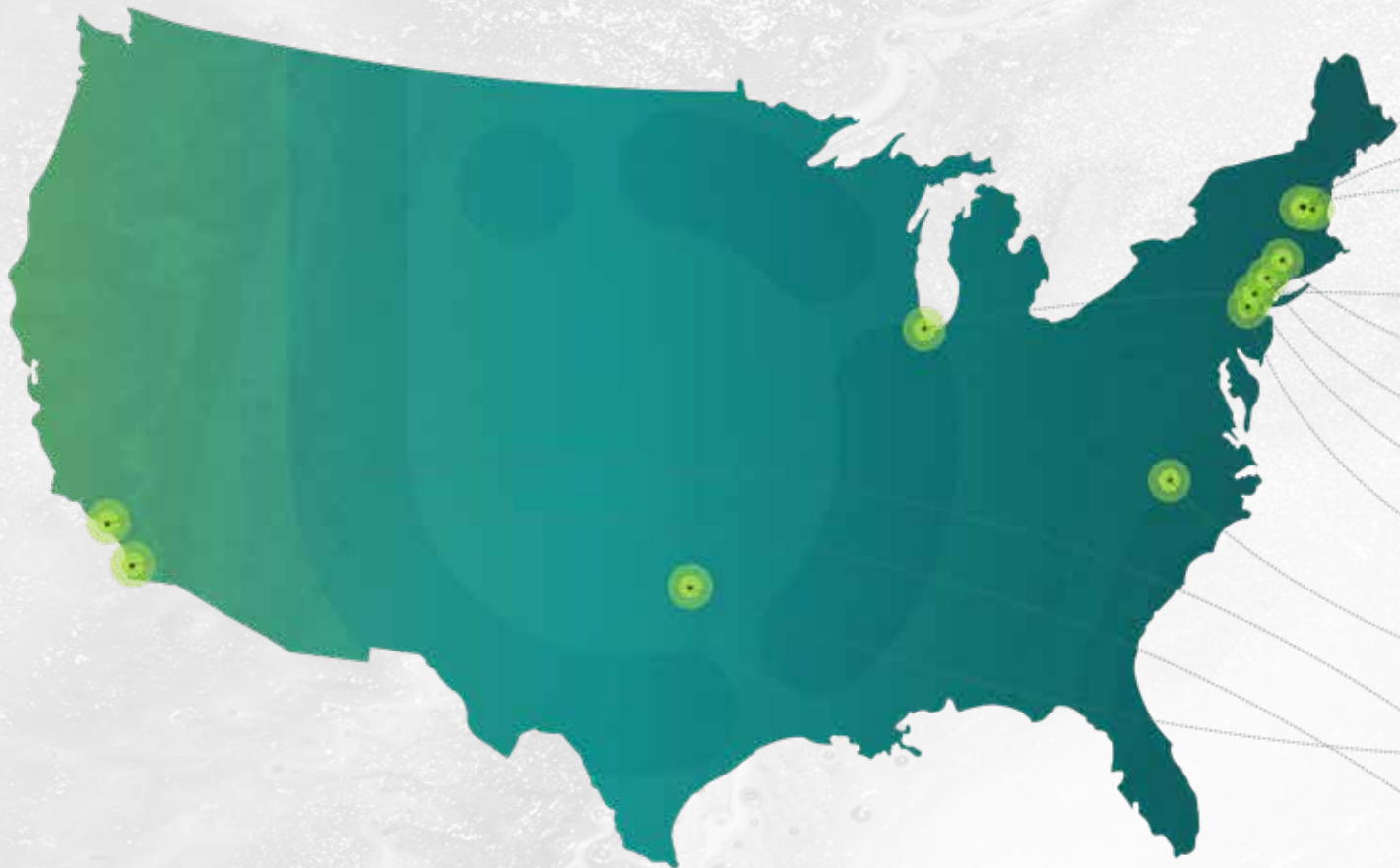

 biolabs

PEGASUS PARK

3060 Pegasus Park Drive
Dallas, TX 75247



- BOSTON, MA**
Tufts Launchpad | BioLabs
- CAMBRIDGE, MA**
Eisai Innovation Center BioLabs
- WATERTOWN, MA**
Coming June 2022
- CHICAGO, IL**
Coming 2023
- NEW HAVEN, CT**
BioLabs New Haven
- NEW YORK, NY**
BioLabs at NYU Langone
- PRINCETON, NJ**
Princeton Innovation Center BioLabs
- PHILADELPHIA, PA**
BioLabs Philadelphia
- DURHAM, NC**
BioLabs North Carolina
- DALLAS, TX**
BioLabs at Pegasus Park
- LOS ANGELES, CA**
BioLabs at the Lundquist Institute
- SAN DIEGO, CA**
BioLabs San Diego



An International Network

Our Mission

BioLabs designs and operates premium lab and office spaces around the world. Through strategic partnerships with prominent real estate developers and premiere innovation partners, BioLabs has grown a network in Class-A laboratory buildings across established and emerging biotech clusters.

Flexible terms, world-class amenities, and white glove services allow life science innovators to work, collaborate, and host events. And by admitting only the most promising companies, BioLabs members are surrounded by a community of peers.



PARIS, FR
Coming 2022

SACLAY, FR
Coming 2023

HEIDELBERG, DE
Coming 2022

Biotech in North Texas

As innovation ecosystems are saturating the East and West coasts, Dallas has leapt at the opportunity to expand biotech development in the middle of the country.

Dallas offers access to a robust scientific environment and a rich core of academic institutions:

University of Texas Southwestern Medical Center

University of Texas Dallas

University of Texas Arlington

Southern Methodist University

University of North Texas

Texas Christian University

Grant funding opportunities: the state of Texas is **ranked #2** for number of grants awarded annually.

The Dallas/Forth Worth region is **ranked #1** in the country for job creation.

Access to a thriving and growing pool of biotech and life science companies: **60+** biotech and life science and **23+** fortune 500 companies.

Accelerators in North Texas

MassChallenge

MassChallenge is a global non-profit organization aimed at supporting innovation through collaboration and development. MassChallenge invests in North Texas entrepreneurship by hosting a zero-equity, industry agnostic, early-stage accelerator program at Pegasus Park for startups. Participants can expect hands-on support from top mentors and experts, free co-working space for the duration of the program, access to MassChallenge's unrivalled network of corporate partners, tailored workshops and office hours, and the opportunity to win cash awards and other prizes to top startups.



[Learn more](#)



Blackstone LaunchPad

UT Southwestern's Blackstone LaunchPad (BLP) is the front door to all entrepreneurial tools, programs, and resources on UT Southwestern's campus. BLP provides students, faculty, and postdoctoral researchers access to what they need to pursue entrepreneurial learning and opportunities. UT Southwestern's Blackstone LaunchPad offers entrepreneurial seminars and boot camps via partnerships with organizations such as LaunchBio, 3 Day Startup (3DS), and TechFW, among others. The goal is to educate UTSW students, faculty, and postdoctoral researchers about company formation and to help develop and support entrepreneurial interests in the UTSW community.



[Learn more](#)



Capital Factory

Capital Factory is the center of gravity for entrepreneurs in Texas, the number one startup state in the U.S. Thousands of entrepreneurs, programmers, and designers gather day and night, in-person and online for meetups, classes, and coworking. With boots on the ground in Austin, Dallas, Houston, and San Antonio Capital Factory meets the best entrepreneurs in Texas and introduces them to their next investors, employees, mentors, and customers. According to Pitchbook, Capital Factory has been the most active investor in Texas since 2013.



[Learn more](#)



Health Wildcatters

Health Wildcatters provides investment, networking opportunities, and key resources to support entrepreneurs and startups in the healthcare industry. Health Wildcatters hosts a three-month accelerator program annually for 8 to 12 selected startups. In addition to a diverse curriculum, startups in the accelerator program have access to the Health Wildcatters mentor network. This mentor network provides advice, counsel, and their own personal networks to develop healthcare focused startups. Health Wildcatters also leases furnished office space to health focused startups and companies.



[Learn more](#)



BioLabs Pegasus Park

About BioLabs Pegasus Park

BioLabs is partnering with Lyda Hill Philanthropies to launch a new premium 32,000 sq. ft. life science coworking facility. BioLabs Pegasus Park is the first BioLabs location in the central United States, and the first life science coworking space in North Texas.

Targeted at high-potential, early-stage scientific ventures, the site offers Class-A shared and private laboratories, as well as premium office space. Flexible, fully equipped, and supported by a staff of scientists, the site offers over \$2MM in shared equipment and access to many academic institutes in the North Texas region.

Strategically located in the heart of the rapidly expanding innovation district of North Texas in Dallas, BioLabs Pegasus Park supports the growth of the startup ecosystem in North Texas and helps to position Dallas as the next major hub for biotech and healthcare innovation.



+





About Pegasus Park

Pegasus Park is a 23-acre future-focused campus dedicated to innovative companies and nonprofits. It is conveniently located between the Design District and the Southwestern Medical District in Dallas, Texas.

J. Small Investments, in partnership with Lyda Hill Philanthropies, is repurposing the campus into a center for business, social impact, and biomedical innovation exemplifying the spirit that has made Dallas one of the nation's most dynamic cities.

Pegasus Park is anchored by four clusters of activity:

BioTech+ Hub

State-of-the-art facilities supporting life science and healthcare innovators and entrepreneurs.

Water Cooler

150,000 sq. ft. of flexible office space to support non-profit and social impact tenants.

Commercial Tenants

18-story main tower, 593,985 sq. ft.

Convene

Entertainment, dining, and conference center.



Membership Benefits and Services

Access to premium lab and office space.

Centralized group purchasing system—BioLabs Marketplace is a pharma-grade procurement system that simplifies your accounting, offers dramatic discounts from top life science vendors, and includes shipping and receiving services.

Ready-to-go labs—Get pipettes in hands on your first day. BioLabs provides everything you need to move swiftly. We take care of permits, temperature-tracking for cold storage, lab coats, LN2 and CO2... all the little pieces you need to start immediately.

Unmetered access to shared resources.

A full suite of state-of-the-art shared equipment—Unmetered access to cutting-edge qPCR, HPLC, flow cytometry, microscopy, tissue culture suites, cold storage, and much more – all maintained and managed by a team of BioLabs scientists.

On-site concierge services including scientific support and events staff.

Full Environmental Health & Safety support and hazardous waste disposal including chemical and biohazard waste disposal, safety training for your team, and incident response planning.

Ultra-flexible membership terms—Rent one bench at a time, one month at a time. Grow organically, without a long-term commitment!

Access to leading community and industry partners including top pharma companies and life science groups.

Programming and networking—Educational and social events hosted by wide network of sponsors and business leaders from the biotech and pharma industries.

Access to core facilities and services through our partnerships with many local academic institutes.





Membership Benefits and Services

Lab Equipment and More

- HPLC
- Microscopes
- 3D Printers
- Blot and Gel Imagers
- Plate Readers & Washers
- Multiplex Systems
- Cell Counters
- Thermal Cyclers
- Fume Hoods
- Sterilizers and Autoclaves
- Freezers (-80° and -20°)
- Refrigerators
- Centrifuges
- Biosafety Cabinets
- Chemical Storage

Core Facilities

University of Texas Southwestern Medical Center (UTSW)

- DNA Genotyping
- Flow Cytometry Core
- Human Genetics Clinical Laboratory
- Mouse Genome Engineering Core
- Next Generation Sequencing Core
- Proteomics Core
- Sanger Sequencing Core
- and more

University of Texas at Arlington (UTA)

North Texas Genome Center

The Shimadzu Institute for Research Technologies

University of Texas at Dallas (UTD)

- Imaging and Histology Core
- Genome Center
- Molecular and Protein Analysis Core
- Flow Cytometry Core
- Mass Spectrophotometer Core
- Advanced Electrical Characterization Lab



For pricing, visit biolabs.io/north-texas



Monthly Membership

\$300 Per Person

Access to conference rooms, event space and non-laboratory amenities.

PLUS



Laboratory Bench

\$1,800 Per 6 ft. Bench *Per Month*

Access to fully equipped co-working laboratory. Start with a single bench and scale up as you grow. Private labs also available. Inquire for pricing.

OR



Private Lab

Inquire for Pricing

PLUS



Office Workstation

\$250 Per Workstation *Per Month*

Access to fully equipped co-working office workstations and non-laboratory amenities.

OR



Private Office

\$1,800-\$2,400 Per Office *Per Month*

Floor Plan

28 Private Offices

40+ Desks in Shared Office Space

100+ Lab Benches in Shared Lab Space

5 Private Labs

11 Conference Rooms

Common Support Labs

- Tissue Culture
- Pre PCR
- Bioengineering
- Microscopy
- Refrigerators and Freezers
- and more

Common Areas

- Phone Rooms
- Café
- Wellness Room
- Event Spaces
- and more



Scan QR Codes for 360° 3D Rendering of Space



Laboratory



Corridor



Workstation



Reception



Lounge

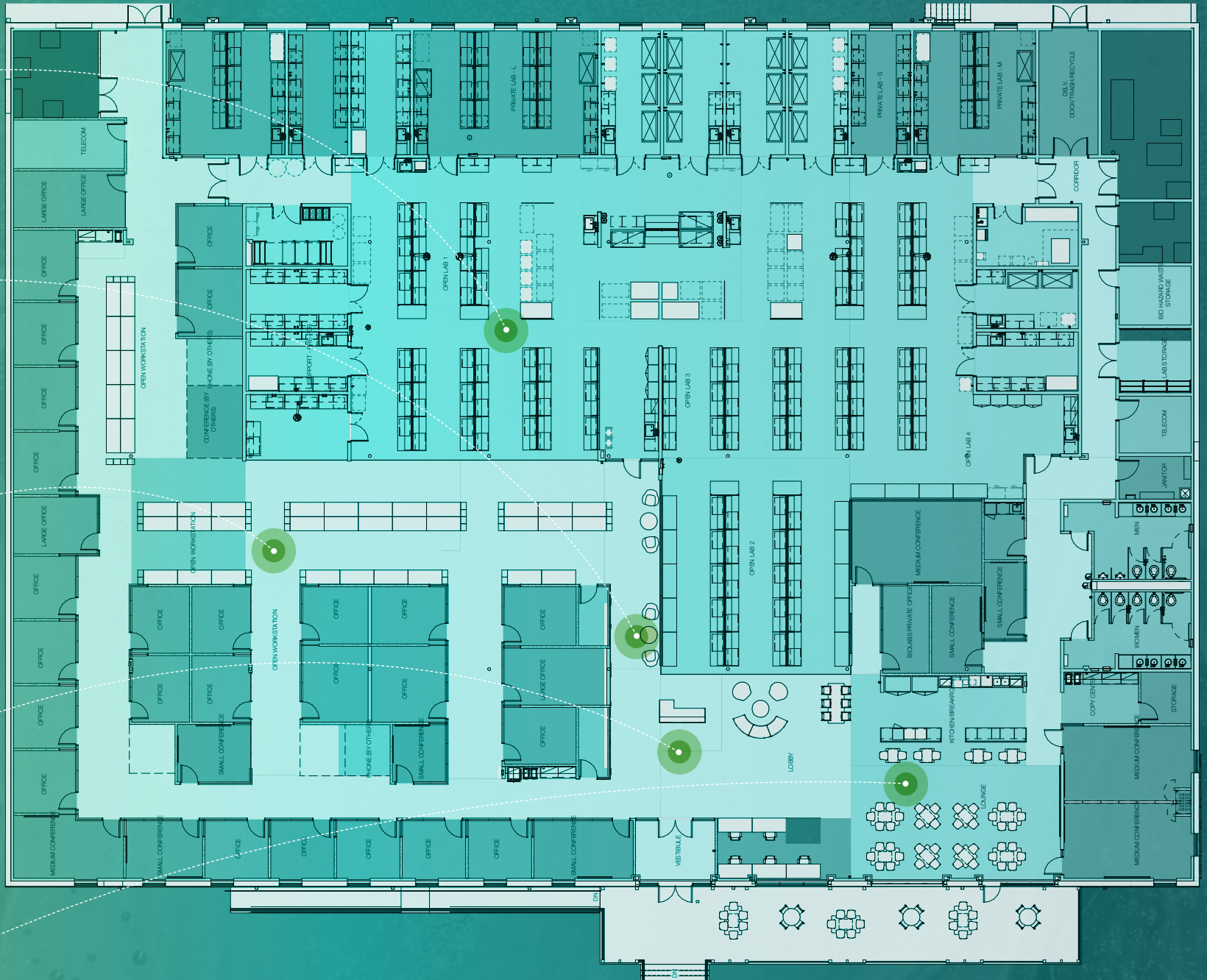

Sponsorship Opportunities

BioLabs Pegasus Park offers great sponsorship and partnership opportunities. This allows our sponsors and partners to support and engage with innovative local life science startups that are developing groundbreaking technologies. It also enables opportunities to build long term relationships and establish partnerships between sponsors and BioLabs' resident companies.

BioLabs works with sponsors from different sectors of the life sciences community, including:

Pharmaceutical companies

Biotech companies

Analytical instrumentation companies

Legal firms, CRO's

Academic Institutions

And more

This diversity supports BioLab's overall mission of providing the best services and network to our resident companies and enables them to focus on their meaningful science.

Inquiries

BioLabsNTX@biolabs.io
or **sponsorship@biolabs.io**

		MOST POPULAR		
	Founding Sponsorship	Platinum Sponsorship	Gold Sponsorship	General Sponsorship
RECOGNITION				
Seat on Selection Committee	✓	-	-	-
Exclusivity, per site maximum of 5 total and 3 per industry	✓	-	-	-
Named at BioLabs' public events	✓	✓	-	-
Opportunity to distribute jointly approved press release announcing sponsorship	✓	✓	✓	-
Named in BioLabs' collateral (digital & print) and social media feeds	✓	✓	✓	✓
Permission to cross-promote use of logos onsite and on the website	✓	✓	✓	✓
ACCESS TO THE SITE				
Badge access	✓	-	-	-
Opportunity to host on site events (each year)	12	4	2	1
Opportunity to host office hours (each year)	Monthly	Monthly	Quarterly	Quarterly
Opportunity to rent office space onsite	✓	-	-	-
Invitation to BioLabs grand opening and general events	✓	✓	✓	✓
Invitation to BioLabs VIP events	✓	✓	-	-
Opportunity to provide speakers at BioLabs events	✓	✓	-	-
GOLDEN TICKETS*				
Golden tickets included with cash sponsorship	3	2	1	-
Opportunity to purchase additional Golden Tickets for \$75,000	✓	✓	✓	-

* **Golden Ticket**—Ability to support an individual company by funding a lab bench rental onsite for 1 year. Golden Tickets may be excluded for a lower contribution.



PEGASUS PARK

3060 Pegasus Park Drive
Dallas, TX 75247

If you are interested in becoming a resident of BioLabs Pegasus Park, please contact: biolabsNTX@biolabs.io

For sponsorship, please contact:
sponsorship@biolabs.io



Thank You to Our Sponsors



Agilent

DeNovix

eppendorf



JLL

LI-COR

Miele

MILLIPORE
SIGMA

PHCBI

Promega

SHIMADZU
Excellence in Science

ThermoFisher
SCIENTIFIC